



Fógra an Phlean

KE58261F

XY 697250, 713959

Kilmalum

S.C.D1

23-09-25D

Teideal Lodial/Allodial:

Barra de Róiste

Leas Tairbhiúil:

Iontaobhas Teaghlaigh an Róistigh

Leas Cothromasach:

Barra de Róiste / Caroline Steedman

Cur Síos Dleathach:

Talamh agus Teaghais ag Cill Moluim An Nás Theas Cill Dara Éire

Leas Dlíthiúil:

BARRA DE ROISTE

Cur Síos Dlíthiúil:

The property shown Red plan(s) BDX9G on Registry Map in
Townland of KILMALUM Barony of NAAS SOUTH, Electoral Division
of NEWTOWN Folio 58261F.

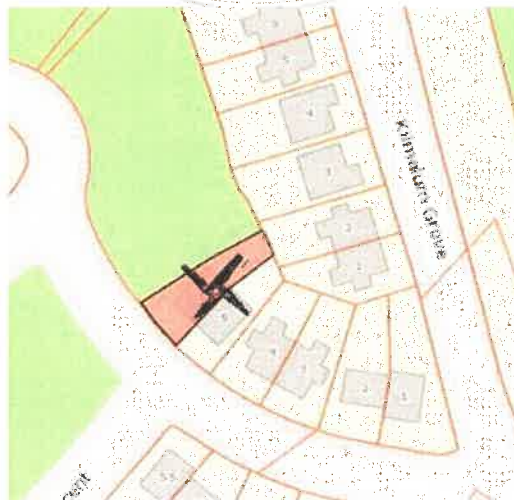



Plan Notice

KE58261F

XY 697250, 713959

Kilmalum

S.C.D1

23-09-25D

Lodial/Allodial Title:

Barra de Róiste

Beneficial Interest:

The de Róiste Family Trust

Equitable Interest:

Barra de Róiste / Caroline Steedman

Lawful Description:

Land and Dwelling at Kilmalum Naas South Kildare Éire

Legal Interest:

BARRA DE ROISTE

Legal Description:

The property shown Red plan(s) BDX9G on Registry Map in Townland of KILMALUM Barony of NAAS SOUTH, Electoral Division of NEWTOWN Folio 58261F.

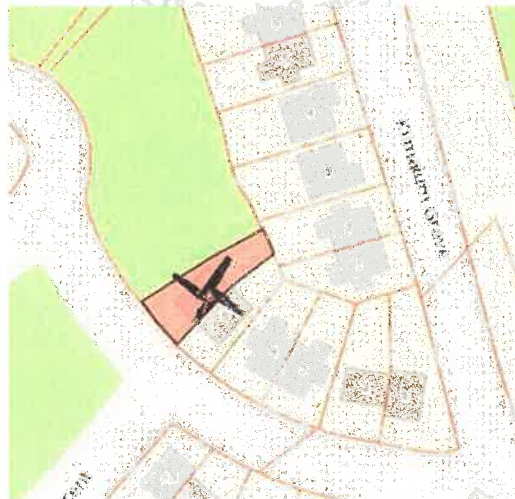
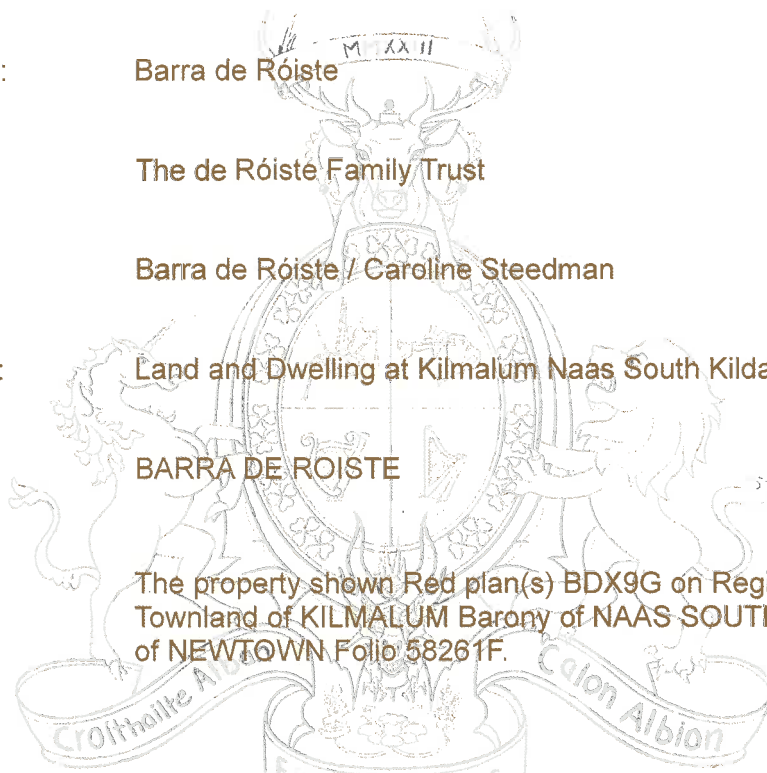

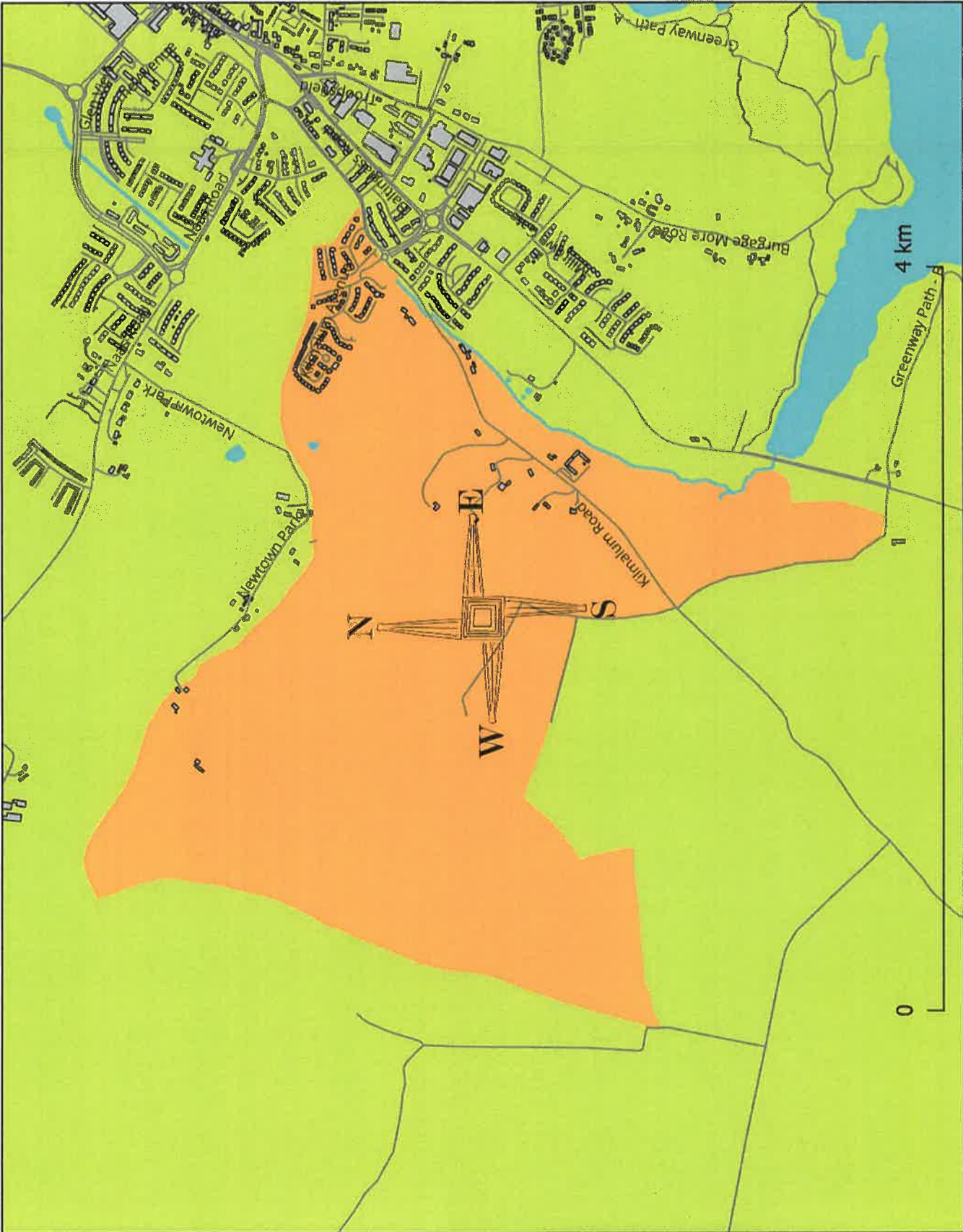

Townland of Killmalum

